

**ORGANIZED BY**

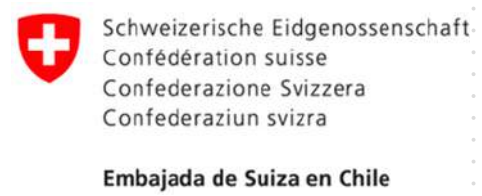

**SUPPORT**



# SWISS PAVILION EXPONOR 2024

**CONTACT**

**Isidora Pérez de la Carrera**  
Projects Director  
Swiss Chilean Chamber of  
Commerce  
+569 84245385  
[ipdelacarrera@swisschile.cl](mailto:ipdelacarrera@swisschile.cl)

# AN INNOVATIVE SWISS PAVILION

- An innovative concept with a 96 square meter open space including eight stands where each company will expose their technologies and innovations.
- It includes a meeting lounge in the center of the pavilion reserved to the members.
- The aim is to create synergies between our members under the attractive swiss brand umbrella.



# AN INNOVATIVE SWISS PAVILION



Exhibitors exhibition area

Meeting area

EN ESTA LAMINA SON PROPIETARIOS  
POR NINGUNA PERSONA, FIRMA O COR



# AN INNOVATIVE SWISS PAVILION

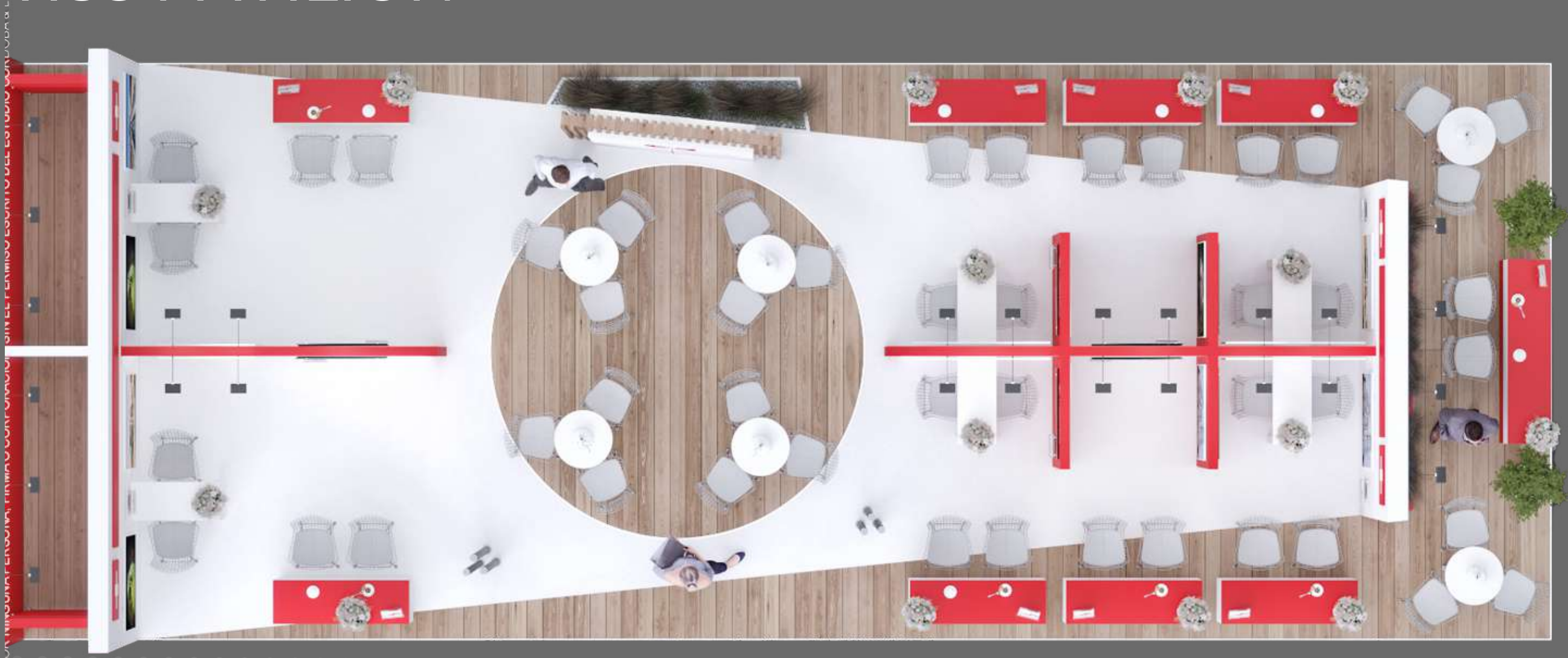

# AN INNOVATIVE SWISS PAVILION

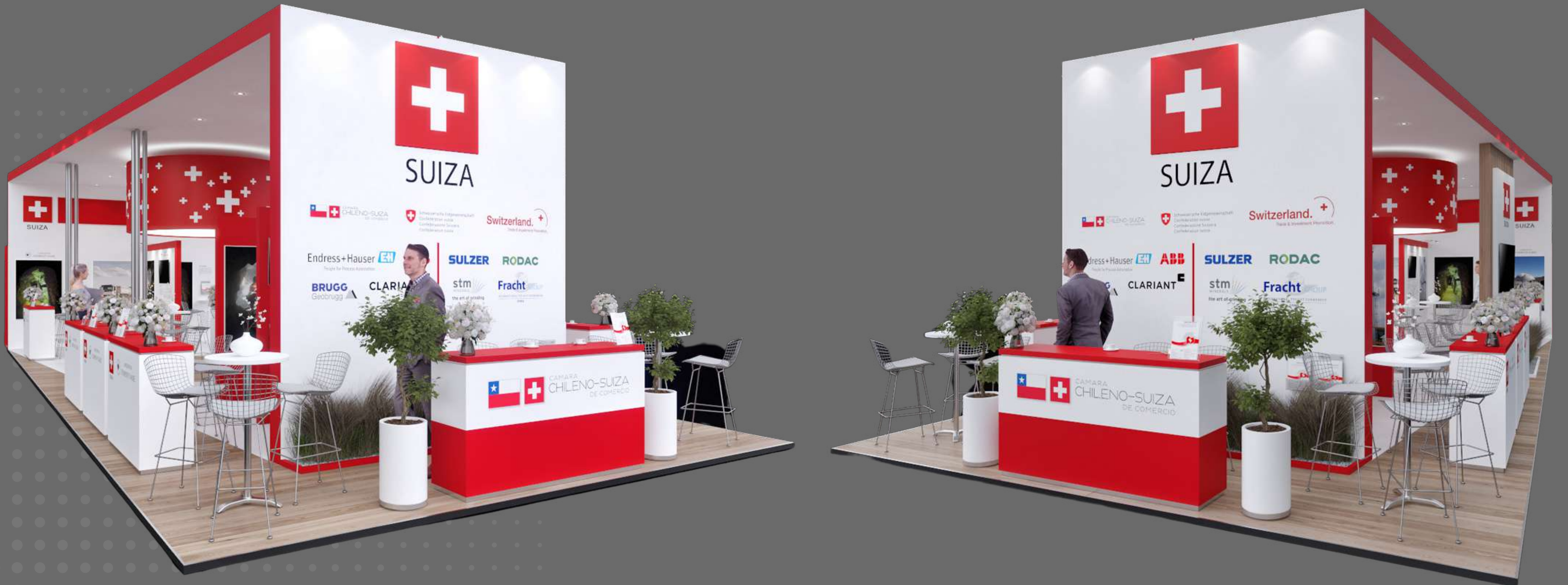

# AN INNOVATIVE SWISS PAVILION

STAND 10MT2

STAND 5MT2



# AN INNOVATIVE SWISS PAVILION

## STAND 10MT2

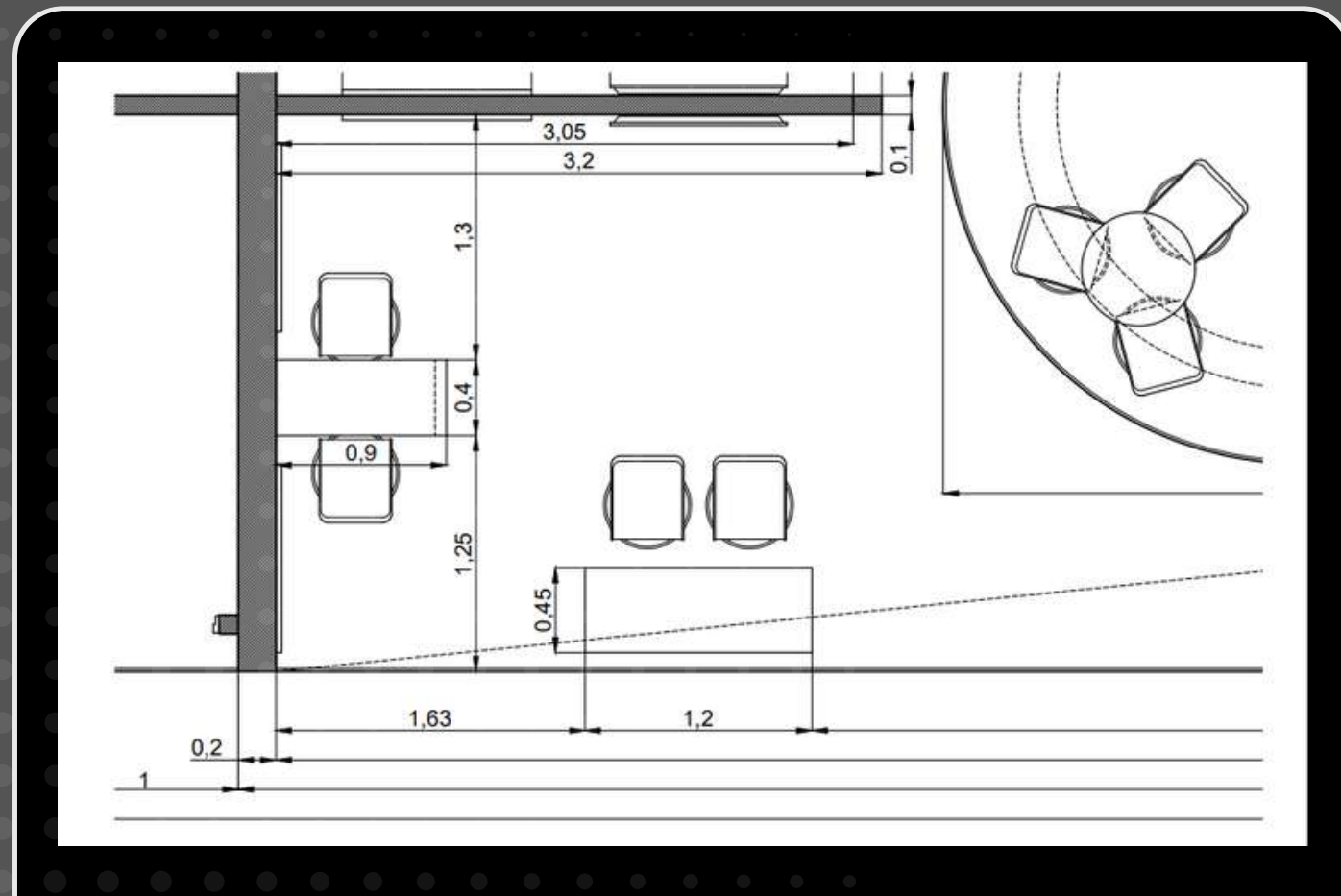

## STAND 5MT2

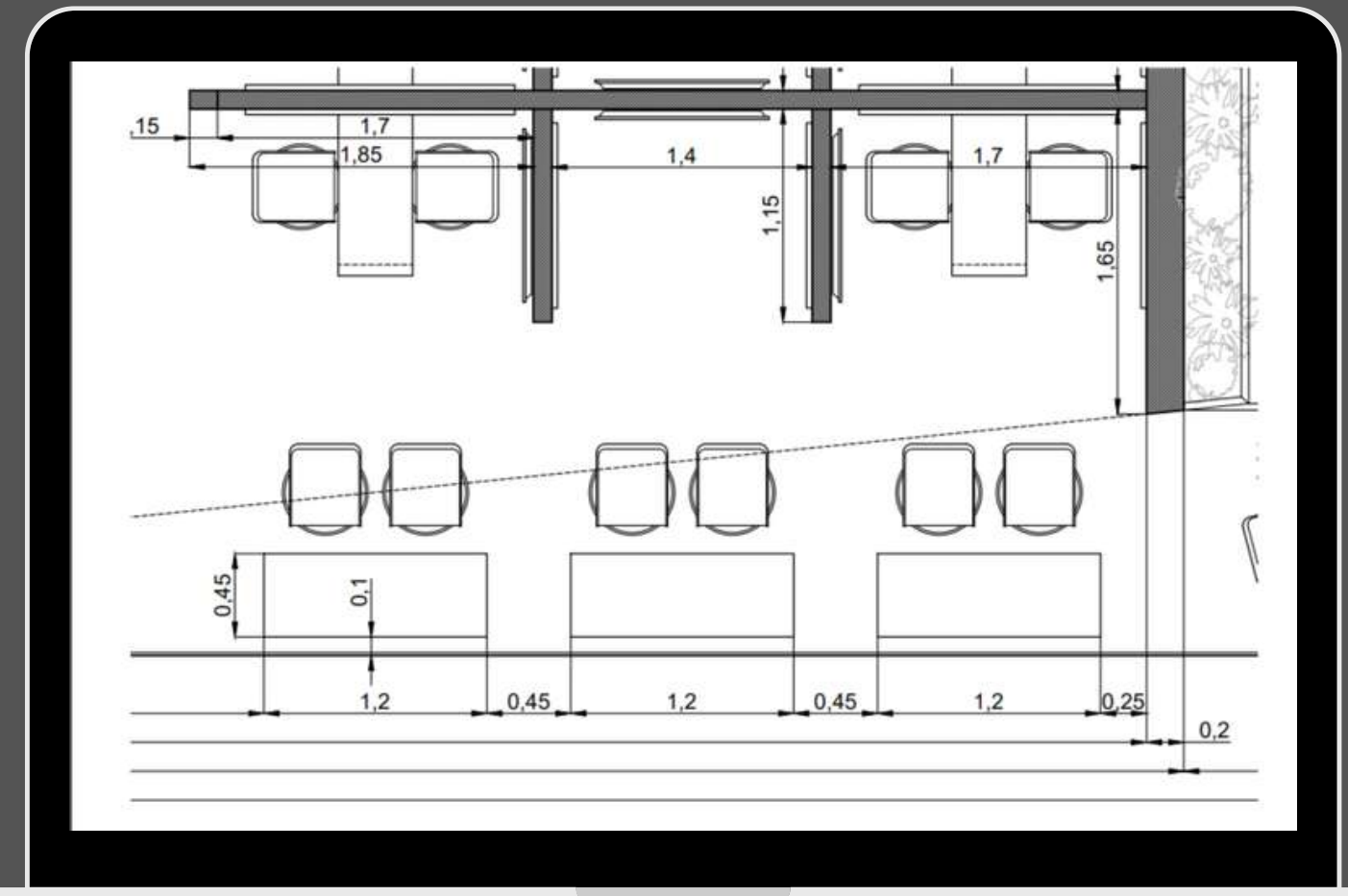

# SWISS PAVILION SERVICES

## THE SERVICES THAT ARE INCLUDED:

- Framework program with the Swiss Business Hub and the Swiss Embassy.
- Permanent service & support during the fair, by the chamber.
- Logistics and coordination with the Fair.
- Production of the stand, furniture and assembly of the corporate image of your company.
- General services at the stand for electricity, Wi-Fi, cleaning and security.
- Transportation service from the NH hotel to the fair (and vice versa).
- Coordination for exhibitor credentials and courtesy tickets.
- Communication strategy and social media of the Chamber.
- Additional services and permanent support during fair days.

INAUGURATION & COCKTAIL WITH THE SWISS EMBASSY, SWISS BUSINESS HUB AND OTHER AUTHORITIES.





# SWISS PAVILION FRAMEWORK PROGRAM

## Sunday 2nd (Antofagasta)

- Flight to ANF
- 8 pm - Briefing and Welcome Dinner for delegation (self paid)

## Monday 3rd (Antofagasta)

- 9 am - Visit trade fair
- 8 pm - Swiss / German Reception in hotel in Antofagasta with the German Chamber of Commerce and its companies

## Tuesday 4th (Antofagasta)

- 9 am - Visit trade fair
- All day - Visit to energy and mining project



# SWISS PAVILION FRAMEWORK PROGRAM

## Wednesday 5th (Antofagasta)

- 9 am - Visit trade fair
- Technical talk at congress with the Swiss experts
- 5 pm - Swiss Mining and Energy Networking Event at Swiss Pavilion

## Thursday 6th (Santiago - Antofagasta)

- 9 am - Visit trade fair
- Technical talk at congress with the Swiss experts
- 3 pm - Flight to SCL
- 7 pm - Networking Cocktail at the Ambassador's residence in Santiago



# LOCATION

SWISS PAVILION  
STAND 805-814  
STAND 96 M2

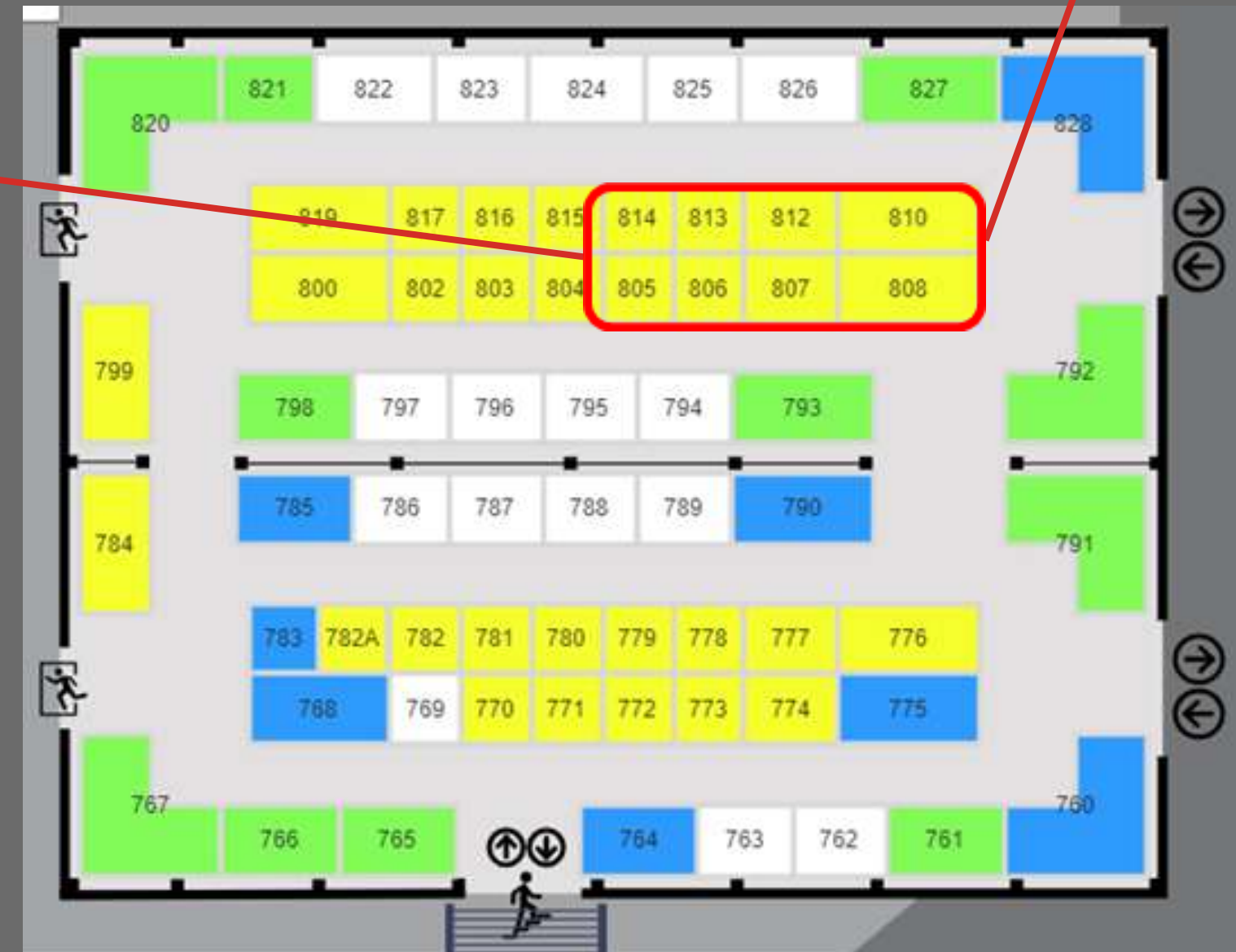

# EXHIBICIÓN INTERNACIONAL DE TECNOLOGÍAS E INNOVACIONES PARA LA INDUSTRIA MINERA Y ENERGÉTICA

**EXPONOR**  
**CHILE 2024**



**3 - 6 junio 2024**  
**ANTOFAGASTA - CHILE**

ORGANIZA



ASOCIACIÓN  
DE INDUSTRIALES  
ANTOFAGASTA

# GENERAL INFORMATION



**+40.500** INDUSTRY  
PROFESSIONALS

**+28** DIFFERENT  
COUNTRIES AT THE  
FAIR

**+730** EXHIBITORS  
AND SPONSORS

**+112 mil** M2 EXHIBITION

# WHAT WE REQUEST FROM THE COMPANIES

- Videos to display on the screen of the designated space (mp4 format).
- Company logo (ai format. and png.)
- Graphics with the measures requested by the producer (illustrator format).
- Details of company representatives.
- Information about the best practices, innovations, news about the products and services or any other relevant element to highlight during the Fair, to publish in our social networks and deliver to the fair's communications.

# PRICES ALL INCLUDED

Space of 10 mt2	360 UF (+ IVA)
Space of 5 mt2	230 UF (+ IVA)
Logo participation	100 UF (+ IVA)





CAMARA  
CHILENO-SUIZA  
DE COMERCIO

## CONTACT

Isidora Pérez de la Carrera  
Projects Director  
Swiss Chilean Chamber of Commerce  
+569 84245385  
[ipdelacarrera@swisschile.cl](mailto:ipdelacarrera@swisschile.cl)

 [Cámara Chileno Suiza de Comercio A.G](#)

 [@ChilenoSuiza](#)

 [@swisscham\\_chile](#)

 [Cámara Chileno Suiza de Comercio](#)

 [Cámara Chileno Suiza](#)

 [info@swisschile.cl](mailto:info@swisschile.cl)

 [www.swisschile.cl](http://www.swisschile.cl)